



STRATA

SUPERIOR WELDING PRODUCTS

EZIARC 160 • EZIARC 200

MMA (STICK) WELDER

The EZIARC Series of MMA (stick) Welders pack a punch at a lightweight 3.8kg. Built tough for on-site work & engineering applications and they are also very versatile having the latest hot start/antistick technology with easily control of 1.6mm to 5.0mm low hydrogen or general purpose electrodes.



- IGBT Inverter technology for smooth & stable welding output
- Lightweight & compact design for portable applications and rugged conditions
- Production tested to 440V for extreme stress testing in production for rugged reliability
- Strong environmental protection (IP23) for protection against moisture, salt spray and corrosion
- Automatic arc force, hot start & anti-stick for greater control and ease of use
- Lift TIG welding operation for precision in aesthetically important welding jobs (torch optional)
- Digital current display meter for accurate pre-setting and feedback of welding parameters & output
- High quality & over specified electronic components for durability & reliability.



230V 50HZ
SINGLE
PHASE



IGBT
INVERTER
TECHNOLOGY



DIRECT
CURRENT
OUTPUT



SPIKE/
GENERATOR
SAFE



INTELLIGENT
PROTECTION
SYSTEM



IP23 CORROSION
& SALT SPRAY
RESISTANT



LIFT TIG
(OPTIONAL
TORCH)



CONSTANT
CURRENT

EZIARC 160





DIMENSIONS:	WEIGHT:	INPUT POWER SUPPLY:	MAX. INPUT CURRENT:	GENERATOR CAPACITY:	MMA CURRENT OUTPUT:	MMA O/C VOLTAGE:	DUTY CYCLE:	STANDARDS:	MMA ROD SIZE:	MAX WELD THICKNESS
296 x 132 x 260mm	3.8kg	230V AC 15A 50Hz	35A	8 KVA	10A-160A	74V	60% @130A	EN60974-1:2012	1.6 - 4.0mm	8mm

EZIARC 200

DIMENSIONS:	WEIGHT:	INPUT POWER SUPPLY:	MAX. INPUT CURRENT:	GENERATOR CAPACITY:	MMA CURRENT OUTPUT:	MMA O/C VOLTAGE:	DUTY CYCLE:	STANDARDS:	MMA ROD SIZE:	MAX WELD THICKNESS
296 x 132 x 260mm	3.8kg	230V AC 15A 50Hz	47A	11 KVA	10A-200A	74V	60% @145A	EN60974-1:2012	1.6 - 5.0mm	10mm

* 24 Month Warranty only with online registration of product - www.strata.co.nz

MMA (STICK) WELDING ACCESSORIES & CONSUMABLES

ACCESSORY:	EZIARC 160	EZIARC 200	ADVANCEARC 160	ADVANCEARC 200	ADVANCEARC 400	ADVANCEARC 500	XI630ARC
Arc Leads 	○ AAL1625	○ AAL1625	○ AAL3550	○ AAL3550	○ 17479	○ 17479	○ 17479
Earth Leads 	○ AEL1625	○ AEL1625	○ AEL3550	○ AEL3550	○ 17478	○ 17478	○ 17478
TIG Torch 	● TWP17V-12-2D	● TWP17V-12-2D	● TWP17V-25-2	● TWP17V-25-2	● TWP17V-25-2	● TWP17V-25-2	● TWP17V-25-2
Argon Regulator 	● GR101AR	● GR101AR	● GR101AR	● GR101AR	● GR101AR	● GR101AR	● GR101AR
Gouging Torch 	-	-	-	-	● GTK4000	● GTK4000	● GTK4000

○ Standard
● Optional

MMA Welding Electrodes



CODE:	DESCRIPTION:
ETCPH48 25/32/40/50	OVERCORD R92 General Purpose Electrodes
ETCPH68 25/32/40/50	OVERCORD General Purpose Electrodes
ETCPH45 25/32/40/50	SUPERCORD 45 General Purpose Electrodes
ETCPH56S 25/32/40/50	TENAX 56S Low Hydrogen Electrodes
ETCPH77 25/32/40/50	SUPERCITO Low Hydrogen Electrodes

Automatic Welding Helmets

- Variable Shade, 9 - 13 • Complete with batteries ready to go
- Suitable for automotive DIY and industrial use.

DW1500	Auto Welding Helmet, Fixed Shade (MIG/MMA/Plasma)
DW2500	Auto Welding Helmet, Shade 9 - 13 (MIG/MMA/Plasma)
DW3000	Auto Welding Helmet, Shade 9 - 13 + Grind Function (MIG/TIG/MMA/Plasma)
DW4000	Auto Welding Helmet, Shade 9 - 13 + Flip Front (MIG/TIG/MMA/Plasma)
DW7000	Auto Welding Helmet, Shade 9 - 13 + PAPR Air Respirator (MIG/TIG/MMA/Plasma)



Flip Front Welding Helmet

AFF1000	Flip Front Helmet (MIG/ARC/Plasma)
---------	------------------------------------



Welding Magnets

WMG03	3" Welding Magnet
WMG05	5" Welding Magnet

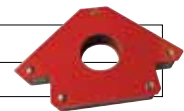

Chipping Hammer

- Heavy duty chipping hammer for the trade

SPCH	Spring Handle Chipping Hammer
------	-------------------------------

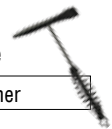

Black/Gold Welders Gloves

- Fully lined • One piece back • Special "comfort fit".

AWG01	Black/Gold Gloves - Pair
-------	--------------------------

Red/Black Premium Welders Gloves

- Fully lined • Premium quality leather
- Reinforced palm • Special "comfort fit".

AWG02	Red/Gold Gloves - Pair
-------	------------------------

Blue/Gold Premium Welders Gloves

- Fully lined • #1 Grade quality leather • Reinforced palm • Kevlar stitching • Special "comfort fit".

AWG03	Blue/Gold Gloves - Pair
-------	-------------------------

TIG Welders Gloves

- Specially designed for TIG welding
- Fine, hardwearing quality leather.

TWG20	TIG Welding Gloves - Pair
-------	---------------------------

Riggers Gloves

- Leather riggers gloves • Very durable quality leather
- Available in M, L & XL sizes.

RWG20	TIG Riggers Gloves - Pair
-------	---------------------------