

MAGNETIC BASE DRILL

HF-750

ORDER CODE: (D9507)

EDITION : 1.0
DATE: (11/24)

The following section covers the spare parts diagrams and lists that were current at the time this manual was originally printed. Due to continuous improvements of the machine, changes may be made at anytime without notification.

HOW TO ORDER SPARE PARTS

1. Have your machines model number, serial number & date of manufacture on hand, these can be found on the specification plate mounted on the machine
2. A scanned copy of your parts list/diagram with required spare part/s identified.

NOTE: SOME PARTS MAY ONLY BE AVAILABLE AS AN ASSEMBLY

3. Go to www.machineryhouse.com.au/contactus and fill out the inquiry form attaching a copy of scanned parts list.

**WARNING!**

*Electricity is dangerous and could cause death
All electrical work must be carried out by a qualified electrician.*

**CAUTION**

It is impossible to cover all possible hazards Every workshop environment is different. These are designed as a guide to be used to compliment training and as a reminder to users prior to equipment use. Always consider safety first, as it applies to the individual working conditions.

SPARE PARTS DIAGRAM

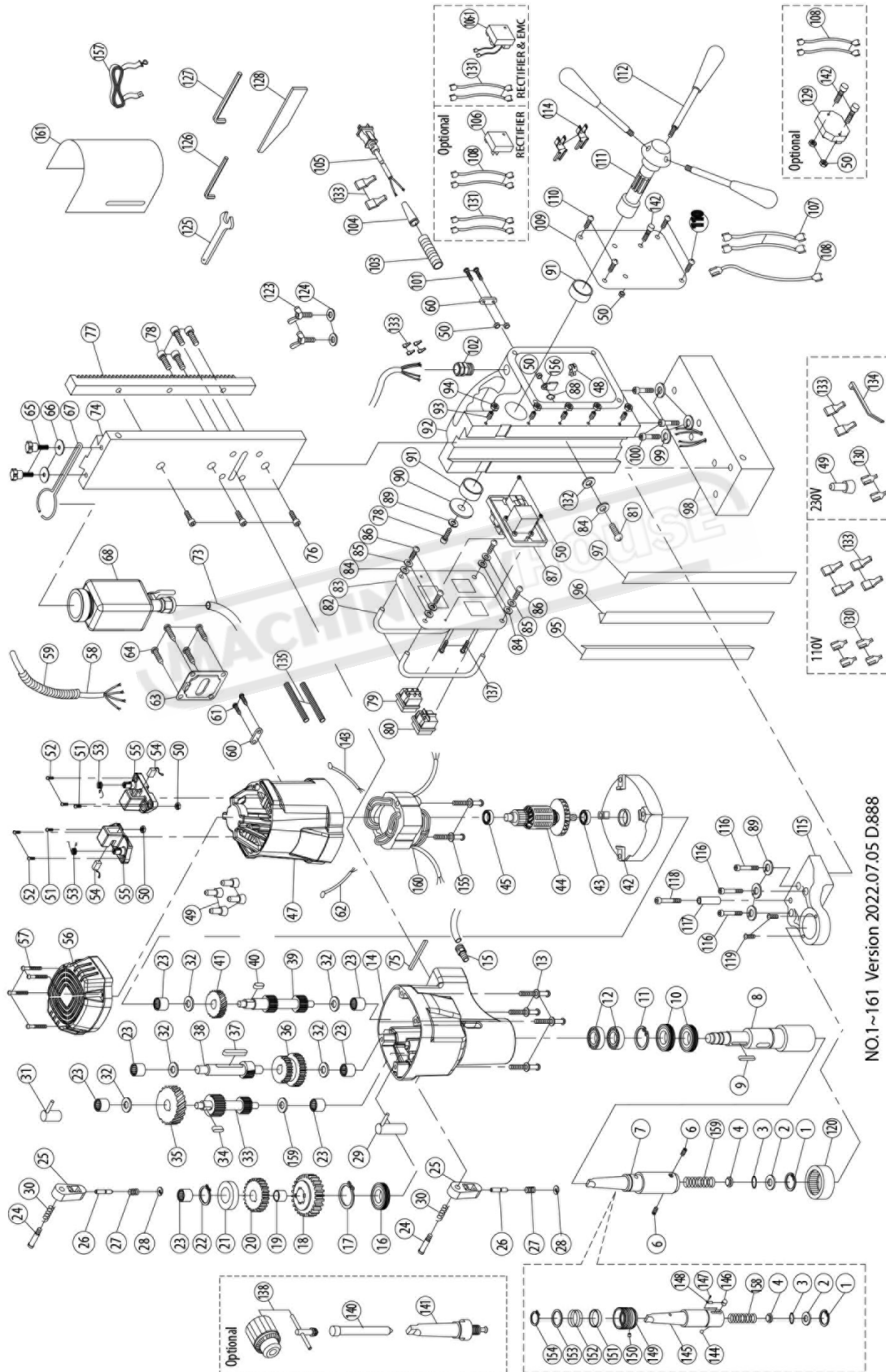

NO.1~161 Version 2022.07.05 D.888

SPARE PARTS LIST

Item	Description	Qty	Item	Description	Qty.
1	INTERNAL CIRCLIP (R-19)	1	57	PANHEAD TAPPING SCREW (M4x20)	4
2	FLAT WASHER (Ø10xØ18.5x0.8)	1	58	WIRE (2.0x4Cx86CM-SJT)	1
3	O-RING (Ø12x4)	1	59	CABLE PROTECTOR (3/8"x50CM)	1
4	WATER SEAL (Ø12x15)	1	60	CABLE CLIP	2
5	SPRING (Ø1.2xØ10xØ12.4x24Tx140L)	1	61	PANHEAD TAPPING SCREW (M4x16)	2
6	SOCKET SET SCREW (M8x7xP1.25)	2	62	WIRE LEAD (1015-16#26CM)	1
7	ARBOR (MT3-Ø19)	1	63	MOTOR COVER PLATE	1
8	SPINDLE (MT3-199.8MM)	1	64	FLAT HEAD TAPPING SCREW (M5x10)	4
9	PARALLEL KEY (5x5x40)	1	65	THUMB SCREW (M5x16)	2
10	OIL SEAL (Ø40xØ55x7)	2	66	FLAT WASHER (Ø5xØ12x1)	2
11	INTERNAL CIRCLIP (R-55)	1	67	COOLANT TANK BRACKET	1
12	BALL BEARING (6006)	2	68	COOLANT TANK ASSEMBLY	1
13	PANHEAD TAPPING SCREW (M5x65)	4	73	TUBE (Ø4xØ6x30CM)	1
14	GEAR HOUSING	1	74	SLIDE PLATE (L348MM)	1
15	PUSH LOCK FITTING (PT1/8"xØ6)	1	75	PARALLEL KEY (4x4x30)	1
16	OIL SEAL (Ø30xØ45x5)	1	76	SOCKET CAP SCREW (M8x20xP1.25)	3
17	EXTERNAL CIRCLIP (S-30)	1	77	GEAR RACK (M2.0x270L)	1
18	LOW SPINDLE GEAR (DP10/12x21T)	1	78	SOCKET CAP SCREW-PARTIAL THREAD (M8-1.25 x 16)	5
19	BUSHING (Ø18xØ20x11.5)	1	79	REVERSING SWITCH (110V&220V)	1
20	HIGH SPINDLE GEAR (M1.75x25T)	1	80	MAGNET SWITCH (110V&220V)	1
21	SPACER (Ø14.2xØ22x5)	1	81	PANHEAD MACHINE SCREW (M4x16xP0.7)	1
22	EXTERNAL CIRCLIP (S-14)	1	82	SWITCH GUARD BAR (110MM)	2
23	NEEDLE BEARING (HK 1010)	7	83	SWITCH PANEL (130.5x90.5x1.5T)	1
24	SHOULDER SCREW	2	84	FLAT WASHER (Ø4xØ10x1)	5
25	SELECTOR TAB	2	85	SPRING WASHER (M4)	4
26	DETENT PIN (Ø5x22.5)	2	86	SOCKET CAP SCREW (M4x16xP0.7)	4
27	SPRING (Ø0.6xØ5.3xØ6.5x17Lx5T)	2	87	MOTOR SWITCH (110V/220V)	1
28	E-CLIP (E-3)	2	88	EXTERNAL STAR WASHER (M5)	1
29	FIRST SELECTOR FORK (Ø12x26 / Ø4x25)	1	89	SPRING WASHER (M8)	4
30	SPRING (Ø1xØ9xØ11x11Lx4T)	2	90	FLAT WASHER (Ø8xØ40x2.5)	1
31	SECOND SELECTOR FORK (Ø12x21 / Ø4x32.2)	1	91	BUSHING (Ø32xØ38x12)	2
32	THRUST RING (1Ø24)	5	92	STAND BODY	1
33	IDLER SHAFT (M1.75x16Tx7T)	1	93	SOCKET SET SCREW (M5x25xP0.8)	5
34	PARALLEL KEY (5x5x10)	1	94	HEX NUT (M5xP0.8)	5
35	IDLER GEAR (M1.75x36T)	1	95	GIB STRIP-LEFT (308MM)	1
36	LAY GEAR (M1.25x28Tx30T)	1	96	GIB STRIP-RIGHT (308MM)	1
37	PARALLEL KEY (5x5x50)	1	97	GIB TENSIONER (308x15x1.2T)	1
38	COUNTERSHAFT (M1.25x12T)	1	98	ELECTROMAGNET (200x100x68)	1
39	INPUT SHAFT (M1.25x12Tx10T)	1	99	SPRING WASHER (M6)	3
40	PARALLEL KEY (5x5x8)	1	100	SOCKET CAP SCREW (M6x20xP1.0)	3
41	INPUT GEAR (M1.0x29T)	1	101	PANHEAD MACHINE SCREW (M4x30xP0.7)	2
42	GEAR PLATE	1	102	CABLE GLAND (3/8")	1
43	BALL BEARING (6202)	1	103	CABLE PROTECTOR (5/16"x7CM)	1
44	ARMATURE (110V/220V-94x54x45)	1	104	CORD ARMOR	1
45	BALL BEARING (6200)	1	105	POWER SUPPLY CABLE (VDE-1.5x3Cx3.5M-H05VVF)	1
47	MOTOR HOUSING (ORANGE-021C)	1	106	RECTIFIER (110&220V)	1
48	CABLE CLAMP	1	106-1	RECTIFIER & EMC (110V)/(110V&220V)	1
49	CRIMP CAP CONNECTOR (C4)	5	107	WIRE LEAD (1015-16#9CM)	2
50	HEX NUT (M4xP0.7)	10	108	WIRE LEAD (1015-16#18CM)	5
51	PANHEAD MACHINE SCREW (M4x10xP0.7)	2	109	SIDE PANEL (130.5x90.5x1.5T)	1
52	PANHEAD TAPPING SCREW (M4x12)	4	110	PANHEAD MACHINE SCREW (M4x8xP0.7)	4
53	BRUSH SPRING (0.4x4x3.5T)	2	111	CRANK SPINDLE (Ø32)	1
54	CARBON BRUSH (7x17x17)	2	112	CRANK HANDLE	3
55	BRUSH HOLDER (7x17)	2	114	THREE WIRE PUSH IN CONNECTOR	2
56	MOTOR TAIL CASTING	1	115	ARBOR SUPPORT BRACKET	1

NOTE: SOME INDIVIDUAL PARTS MAY ONLY BE AVAILABLE AS AN ASSEMBLY

SPARE PARTS LIST

Item	Description	Qty	Item	Description	Qty.
116	SOCKET CAP SCREW (M8x25xP1.25)	3	141	CHUCK ADAPTOR (MT3-5/8")	1
117	TRAVEL STOP (Ø6.5xØ12x34)	1	142	PANHEAD MACHINE SCREW (M4x25xP0.7)	3
118	SOCKET CAP SCREW (M6x45xP1.0)	1	143	WIRE LEAD (1015-16#30CM)	1
119	TRUSS HEAD MACHINE SCREW (M4x6xP0.7)	2	144	CHECK BALL (Ø8)	1
120	NEEDLE BEARING (HK 3516)	1	145	QUICK RELEASE ARBOR SHAFT (MT3)	1
123	BUTTERFLY SCREW (M6x10xP1.0)	2	146	LOCK PIN (12.3MM)/(11.7MM)	1
124	FLAT WASHER (Ø6xØ13x1)	2	147	PANHEAD MACHINE SCREW (M3x4xP0.5)	1
125	WRENCH (M8)	1	148	LOCK PIN SPRING	1
126	HEX KEY (M2.5)	1	149	QUICK-RELEASE COLLAR	1
127	HEX KEY (M4)	1	150	COLLAR PIN (Ø8)	1
128	DRIFT	1	151	RING (Ø40xØ44x9)	1
129	OVER LOAD PROTECTION (110V/220V)	1	152	SPRING (Ø2.3xØ39xØ43.6x3Tx30L)	1
130	FEMALE SPADE TERMINAL	4	153	SPRING SEAT RING (Ø35.1xØ44.5x2)	1
131	WIRE LEAD (1015-16#18CM)	2	154	EXTERNAL CIRCLIP (S-35)	1
132	RUBBER WASHER (Ø4xØ11x1)	1	155	PANHEAD TAPPING SCREW (M5x60)	2
133	SPADE TERMINAL BOOT	10	156	EARTHING MARKING	1
134	ZIP TIE (2.4x100MM)	1	157	SAFETY BELT	1
135	WIRE SLEEVE (Ø4)	2	158	SPRING (Ø1.2xØ10xØ12.4x15Tx100L)	1
137	PANHEAD MACHINE SCREW (M4x20xP0.7)	2	159	THRUST RING (Ø13xØ24x1)	1
138	CHUCK (5/8")	1	160	STATOR (110V/220V-94x54x45)	1
140	PILOT PIN (HSSx77LxØ6.34)/(HSSx103LxØ6.34)	1	161	CHIP GUARD	1
140	PILOT PIN (TCTx90LxØ7.98)/(TCTx90LxØ6.34)	1			
140	PILOT PIN (TCTx106LxØ6.34)/(TCTx108LxØ7.98)	1			

NOTE: SOME INDIVIDUAL PARTS MAY ONLY BE AVAILABLE AS AN ASSEMBLY

ELECTRICAL

